

### Specifications

Current rating:3.0AAC/DC  
Voltage rating:250V AC/DC  
Contact resistance:20m ohm. max.  
Insulation resistance:1000M ohm. Min.  
Withstanding voltage:600V AC for one minute  
Operating temperature range:-40°C to +105°C

### Material and Finish

Insulator:High Temp. Plastic(UL94V-0)  
Contact:Copper Alloy  
Plating:Gold/Selective Gold Plated

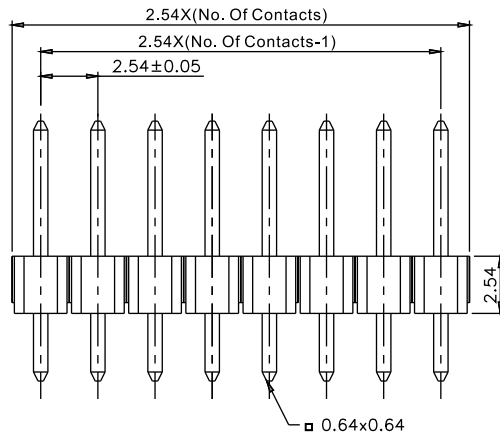

P/N: 2211S-XXG

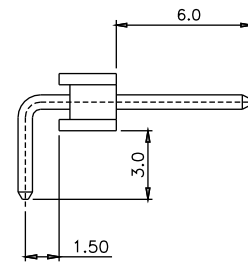

P/N: 2211R-XXG-LP

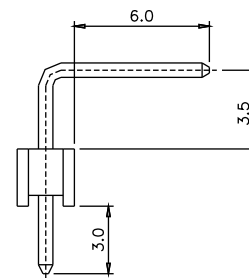
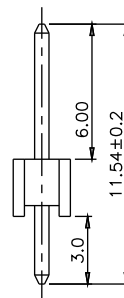

P/N: 2211R-XXG

### Ordering Information

**2211S-XXG-XXXX**

① ② ③ ④

① S: Straight Type	② No. Of Contacts ③ G: Gold Plated SG: Selective Gold	④ Blank Standard Type XXXX: Special Length Of Part No.
--------------------	---	--

**2211R-XXG-LP**

① ② ③ ④

① R: Right Angle Type	② No. Of Contacts ③ G: Gold Plated SG: Selective Gold	④ Blank Standard Type LP: Low Profile Type
-----------------------	---	---

### Recommended PCB Layout

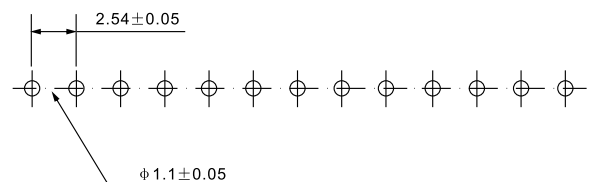

Unit:mm